

FOR REFERENCE ONLY

Applicability: BEECHCRAFT
 Bonanza
 35, A35, B35, C35, D35, E35, F35, G35, 35R [S/N D-71 -> D-4865]

Drawing: AFC-W303
Revision: B
Date: 06/01/05

Airwolf Parts List No. AFC-W303

| <u>Index</u> | <u>Part Number</u> | <u>Description</u> | <u>Quantity</u> |
|--------------|--------------------|------------------------|-----------------|
| 01. | W-3000 | AirSep Assy | (1) |
| 02. | W-2008 | Air Syphon Pump | (1) |
| 03. | MS20823-5D | 45° Fitting, -5 | (1) |
| 04. | W-2018-1 | Air-Tee, 5/8 | (1) |
| 05. | W-2028-1 | Tube | (1) |
| 06. | W-2028-2 | Tube | (1) |
| 07. | W-2027 | Doubler | (1) |
| 08.. | AN970-3 | Flat Washer, 3/16" | (3) |
| 09. | W-2011 | Bracket | (1) |
| 10. | AN526C-1032R10 | Screw, #10 X 5/8" Long | (7) |
| 11. | MS20365-1032A | Locknut, #10 | (7) |
| 12. | AN960-10 | Flat Washer, #10 | (7) |
| 13. | MIL6000-1/4 | Hose, 1/4" ID | (17") |
| 14. | MIL6000-5/16 | Hose, 5/16" ID | (11") |
| 15. | MIL6000-5/8 | Hose, 5/8" ID | (12") |
| 16. | MIL6000-3/4 | Hose, 3/4" ID | (3-1/4") |
| 17. | MM-4 | Hose Clamp, 1/4" | (2) |
| 18. | MM-5 | Hose Clamp, 5/16" | (2) |
| 19. | QS100M10H | Hose Clamp, 5/8" | (6) |
| 20. | QS100M12H | Hose Clamp, 3/4" | (2) |
| 21. | QS100M24H | Hose Clamp, 1-1/2" | (1) |
| 22. | QS100M72H | Hose Clamp, 4-1/2" | (1) |
| 23. | W-2100 | "C" Channel | (10") |
| 24. | MS21919WDG-30 | Adel Clamp, 1-7/8" | (1) |
| 25. | CAT-7 | Duct, 1-3/4" ID | (28") |

*Note A: Some hoses or wires may have to be rerouted so the air/oil separator will fit into position.
Reference and material per AC 43.13-1B & 2A.*

WARNING: ALL HOSES SHALL BE LOCATED AT LEAST 4.0" FROM ANY HEAT SOURCE LIKELY TO CAUSE VAPORIZATION OF THE OIL.

01. Remove the existing air/oil separator, lines and attaching parts.
02. Remove the existing breather tube assy. From the rear engine baffle to the lower cowl flap area, including the 90° elbow fitting installed on the rear baffle.
03. Align the W-2027 doubler with the top edge of the flange on the rear engine baffle. Measure 9.0" from the extreme right edge of the rear engine baffle to the right edge of the doubler (Item 3). Clamp the W-2027 doubler to the rear engine baffle.
04. Duplicate the five (5) holes in the W-2027 doubler (Item 3) through the rear engine baffle.

Note B: The doubler will cover up the hole where the old breather tube went through the baffle.

05. Secure the W-2027 doubler to the rear engine baffle using 1 ea. of items 10, 11, & 12.
06. Secure the W-2011 bracket to the W-2027 doubler and the rear engine baffle using 1 ea. of the items 10, 11, and 12 in the two (2) top holes only.
07. Duplicate the lower holes in the W-2011 bracket through the W-2027 doubler and the rear engine baffle. Place the 4-1/2" clamp between the doubler and the universal bracket just below the 1" notch in the universal bracket. Secure the W-2011 bracket and 4-1/2" clamp to the doubler and the rear engine baffle, using one each of the items 10, 11 and 12.
08. Duplicate the 1-1/8" hole in the rear engine baffle using the W-2027 doubler as a guide.
09. Cut the "B" nut off the breather tube approximately 1.0" forward of the rear engine baffle and install the 3/4" hose and 3/4" clamps loosely over the existing breather tube. NOTE: the 3/4" inch hose will be too large for the breather tube.
10. Position the AirSep on the W-2011 bracket so that the 3/4" inch tube will be pointing forward through the 1.125" hole in the rear engine baffle. Secure it in place using the 4-1/2" clamp.
Note" Cover the 4-1/2" clamp with the W-2100 "C" Channel.
11. Position the 3/4" hose over the 3/4" inch inlet of the AirSep as far aft as it will go. Position the 3/4" clamps over the hose and tighten securely.
12. Remove the elbow fitting from the normal separator drain leaving the reducer bushing in the side of the accessory housing.
13. Install the 45° fitting in the existing reducer bushing, so that it is pointing upwards.
14. Install the Air Syphon Pump with the "Y" pointing upwards.
15. Install the Air-Tee in the 1/2" hose installed on the outlet fitting of the vacuum pump and clamp in place using 1/2" clamps.
Note: Position the Air-Tee exactly as shown.
16. Install the 5/16" hose between the 5/16 branch of the Air Tee and the 5/16" branch of the Air Syphon Pump exactly as shown with the hose loop up.
17. Install the 1/4" hose between the 1/4" AirSep drain fitting and the 1/4" branch of the AirSyphon Pump.
18. Install the 1-3/4" duct onto the bottom of the AirSep and secure with 1-1/2" clamp.
19. Position the lower end of the 1-3/4" duct at the extreme aft lower cowl former, just forward of the cowl flap. Clamp it in place using the -30 Adel clamp the old hardware, and the old breather tube attachment hole.

Note C: The duct must not protrude below the upper edge of the cowl former.

20. Connect the 3/4" engine breather to the 3/4" inlet of the AirSep and secure with 3/4" clamps.
21. Determine weight & balance, initiate Form 337, and update the equipment list.

TOP EDGE OF
REAR ENGINE BAFFLE

**WARNING: ALL HOSES SHALL BE LOCATED
AT LEAST 4.0" FROM ANY HEAT SOURCE
LIKELY TO CAUSE VAPORIZATION OF THE OIL.**

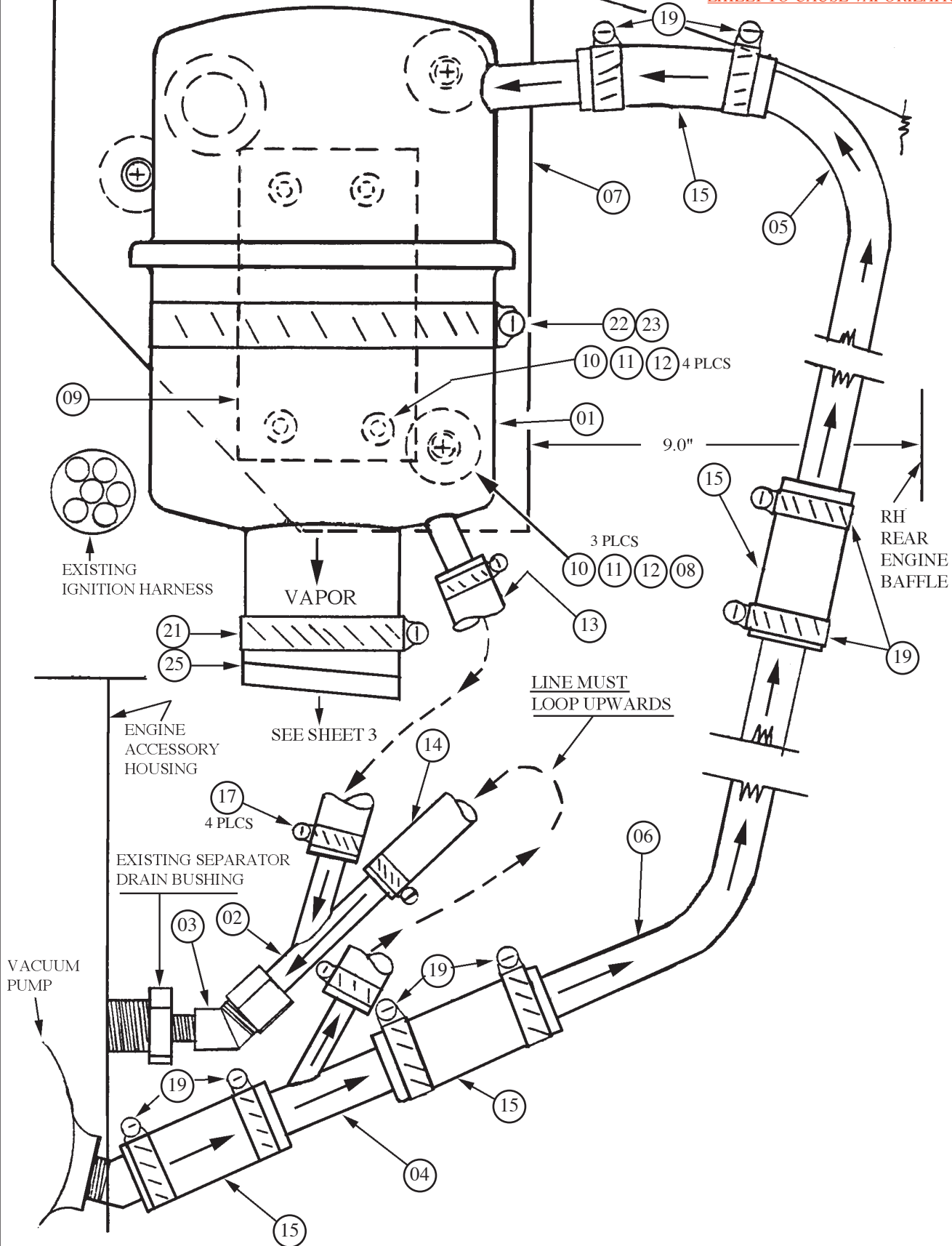

Drawing: AFC-W303
Revision: B
DateP: 06/01/05

[S/N D-71 -> D-4865]

Applicability: BEECHCRAFT
Bonanza
35, A35, B35, C35, D35, E35, F35, G35, 35R

Applicability: BEECHCRAFT

Bonanza

35, A35, B35, C35, D35, E35, F35, G35, 35R

[S/N D-71 -> D-4865]

Drawing: AFC-W303

Revision: B

Date: 06/01/05

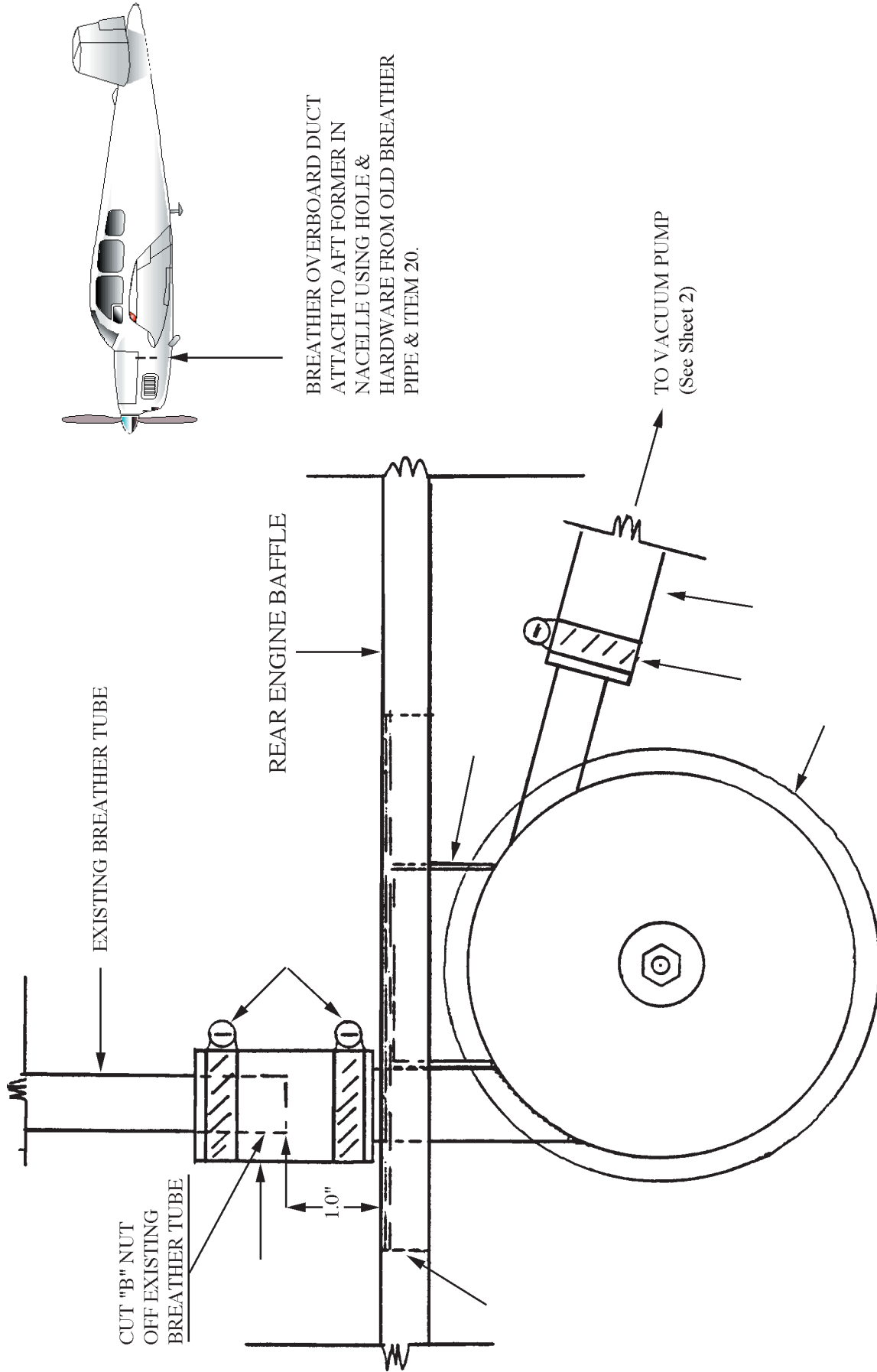

WARNING: ALL HOSES SHALL BE LOCATED AT LEAST 4.0" FROM ANY HEAT SOURCE LIKELY TO CAUSE VAPORIZATION OF THE OIL.