

Oil Filter Kit AFC-K004

Applicability:

Schweizer Model 269 A, B, C & 300C with Lycoming Engines
HO-360-B1A, HO-360-B1B, HIO-360-A1A, HIO-360-B1A,
HIO-360-B1B, HIO-360-D1A, & O-360-C2D

First Release 12/05/92

Amended 01/08/2000

<u>Parts List No. AFC-K004-PL</u>			
<u>Index</u>	<u>Part Number</u>	<u>Description</u>	<u>Quantity</u>
01.	LYC-10	Adapter - Engine, Full Flow	(1)
02.	61173	Adapter Base Gasket	(1)
03.	AN837-8D	Bulkhead Fitting, 45°	(2)
04.	AN6289-8D	Bulkhead Nut	(2)
05.	MS35769-11	Gasket, Oil Temperature Sensor	(1)
06.	MS35769-21	Gasket, Thermostatic Valve	(1)
07.	MS28773-08	Boss Gasket	(2)
08.	MS9387-08	"O" Ring	(2)
09.	AN4H-4A	Bolts, Drilled Head	(4)
10.	AN960-416	Flat Washer	(4)
11.	OFM-14	Oil Filter Mount, 269 A, B, C	(1)
12.	OFB-10	Oil Filter Base	(1)
13.	MS20822-8D	Fitting, 90°	(1)
14.	MS20823-8D	Fitting, 45°	(1)
15.	OFS-10	Oil Filter Stud	(1)
16a.	AFC-500 or	Oil Filter, or Equivalent [Champion CH48108]	(1)
16b.	AFC-600	Oil Filter, or Equivalent [Champion CH48109]	(1)
17.	38B0100008D0211	Hose Assy	(2)
18.	MS21919DG-10	Adel Clamp	(2)
19.	AN3-4A	Bolt	(7)
20.	AN960-10	Flat Washer	(14)
21.	MS20365-1032A	Locknut	(7)
22.	56707	Loctite 567® Teflon Thread Sealant	(1)
23.	AFC-K004-II	Installation Instructions	(1)
24.	AFC-K004-MI	Instructions for Continued Airworthiness	(1)
25.	AFC-K004-PL	Parts List	(1)

Installation Instructions No. AFC-K004-II

Applicability:

Schweizer Model 269 A, B, & C with Lycoming Engines
HO-360-B1A, HO-360-B1B, HIO-360-A1A, HIO-360-B1A,
HIO-360-B1B, HIO-360-D1A, & O-360-C2D

First Release 12/05/92

Amended 01/08/2000

Note A: Some hoses or wires may have to be rerouted so the oil filter assembly will fit into position. Reference and material per AC 43.13-1B & 2A.

Note B: Up until 1987 the optional Paravion cabin heater was usually located on the RH side of the helicopter. After 1987 and in helicopters using the optional searchlight, the Paravion heater can be found on the LH side of the helicopter. The AFC-K004 filter kit is designed to be used in either application. Airwolf Filter Corp. considers the standard configuration for the AFC-K004 oil filter kit to be the LH side of this helicopter.

01. Remove the Lycoming P/N 69510 engine oil screen housing from the accessory case.
 02. Remove oil temperature sensor and thermostatic valve from old oil screen housing.
 03. Per assembly drawing AFC-D-0007, Install a new gasket (05) under the head of the oil temperature sensor, install in the adapter - engine, full flow (01). Turn the oil temp sensor until the sealing surfaces are in contact and then tighten an additional 135 degrees. Install a new gasket (06) under the head of the P/N 75944 Lycoming thermostatic valve, install in the adapter - engine, full flow (01), torque to 300 in/lbs and secure with .032 MS20995-C safety wire.
 04. Refer to assembly diagram AFC-D-0007 and onto each bulkhead fitting (03), install **(in order)** 1 ea. bulkhead nut (04), boss gasket (07), and "O" Ring (08). Install each completed assembly into the oil filter adapter (01).
BE CAREFUL: O-ring and boss gasket must seal in the smooth area between the threaded areas of the bulkhead fitting. Do not tighten fittings until after routing of hoses has been determined in step 06c. or 07c.
 05. Per installation drawing AFC-D-0008, install a new gasket (02) on base of the oil filter adapter (01) and install onto the engine accessory case. On aircraft using the optional Schweizer throttle governor, install flat washers (10) as necessary under the top and bottom throttle governor mounting plate to prevent mounting plate from contacting adapter - engine, full flow (01 and torque to specifications 96 in/lbs.
 - 06a. **LH INSTALLATION (Optional Paravion heater located on RH side of aircraft)**
Using installation drawing AFC-D-0010 as a reference, (facing forward), locate the LH tail rotor bell crank assy. under the LH side of the helicopter. Using the oil filter mount (11) as a template, position 2" forward of the LH tail rotor bell crank assy and drill (6) holes using a #10 drill.
 - 06b. Referencing assembly drawing AFC-D-0011, install fitting (13) into **port "A"** and fitting (14) into **port "B"** of the oil filter base (12) and position per installation drawing AFC-D-0010. Mount to oil filter mount (11) per assembly drawing AFC-D-0011 using bolts (09) and washers (10), and secure with .032 MS20995-C safety wire. Install oil filter mount (11) & oil filter base (12) assembly into previously drilled holes using six ea. screws (19), washers (20), and locknuts (21).
- ** SEE WARNING (B) BELOW ****
- 06c. Install 2 ea. hose assy's (17) connecting the **"A" port** on the filter adapter to the **"A" port** on the oil filter base and the **"B" port** on the filter adapter to the **"B" port** on the oil filter base per installation drawing AFC-D-0010. Tighten bulkhead nuts (04) at this time and then tighten hose fittings to 270-350 in/ lbs.
- ** SEE WARNING (A) BELOW ****
- 06d. Secure hoses per installation drawing AFC-D-0010 using clamps (18), screws (19), washers (20), and nuts (21) provided.

**** WARNING (A) ****

NO ROUTING OF FLAMMABLE FLUID LINES ABOVE EXHAUST SYSTEM, UNLESS SHROUDED. INSTALLER IS RESPONSIBLE FOR INTER-RELATIONSHIP BETWEEN THIS AND OTHER ENGINE CHANGES (INCLUDING ACCESSORIES)

**** WARNING (B) ****

USE LOCTITE® 567 PST TEFLON THREAD SEALANT BEFORE INSTALLATION OF FITTINGS. DO NOT ASSEMBLE FITTINGS INTO OIL FILTER BASE WITHOUT SEALANT OTHERWISE GALLING OF MATERIAL WILL RESULT.

Installation Instructions No. AFC-K004-II

Applicability:

Schweizer Model 269 A, B, & C with Lycoming Engines
HO-360-B1A, HO-360-B1B, HIO-360-A1A, HIO-360-B1A,
HIO-360-B1B, HIO-360-D1A, & O-360-C2D

First Release 12/05/92

Amended 01/08/2000

- 07a. **RH INSTALLATION (Optional Paravion heater located on LH side of aircraft)**
Using installation drawing AFC-D-0009 as a reference, (facing forward), locate the RH tail rotor bell crank assy. under the RH side of the helicopter. Using the oil filter mount (11) as a template, position 2" forward of the RH tail rotor bell crank assy and drill (6) holes using a #10 drill.
- 07b. Referencing assembly drawing AFC-D-0012, install fitting (14) into **port "A"** and fitting (13) into **port "B"** of the oil filter base (12) and position per installation drawing AFC-D-0009. Mount to oil filter mount (11) per assembly drawing AFC-D0012 using bolts (09) and washers (10), and secure with .032 MS20995-C safety wire. Install oil filter mount (11) & oil filter base (12) assembly into previously drilled holes using six ea. screws (19), washers (20), and locknuts (21). Assure adequate clearance between fitting (13) and tail rotor pulley guard bolt and install shorter bolt if necessary.
- ** SEE WARNING (B) BELOW ****
- 07c. Install 2 ea. hose assy's (17) connecting the **"A" port** on the filter adapter to the **"A" port** on the oil filter base and the **"B" port** on the filter adapter to the **"B" port** on the oil filter base per drawing AFC-D-0009. Tighten bulkhead nuts (04) at this time and then tighten hose fittings to 270-350 in/ lbs.
- ** SEE WARNING (A) BELOW ****
- 07d. Secure hoses per installation drawing AFC-D-0009 using clamps (18), screws (19), washers (20), and nuts (21) provided.
08. Install oil filter (16), torque per instructions on oil filter and secure with .032 MS20995-C safety wire.
09. Run engine and check for leaks.
10. Determine weight and balance, initiate a 337 form, and update the equipment list.

**** WARNING (A) ****

NO ROUTING OF FLAMMABLE FLUID LINES ABOVE EXHAUST SYSTEM, UNLESS SHROUDED. INSTALLER IS RESPONSIBLE FOR INTER-RELATIONSHIP BETWEEN THIS AND OTHER ENGINE CHANGES (INCLUDING ACCESSORIES)

**** WARNING (B) ****

USE LOCTITE® 567 PST TEFLON THREAD SEALANT BEFORE INSTALLATION OF FITTINGS. DO NOT ASSEMBLE FITTINGS INTO OIL FILTER BASE WITHOUT SEALANT OTHERWISE GALLING OF MATERIAL WILL RESULT.

INSTRUCTIONS FOR CONTINUED AIRWORTHINESS

Form AFC-K004-ICA Revised 10/01/00

A/C Make : SchweizerModel: 269 A, B, C & 300C S/N: _____ Reg#: _____Revision: Date: 01/08/2000

This sixteen item checklist are Instructions for Continued Airworthiness (ICA), to comply with FAA Handbook Bulletin for Airworthiness (HBAW-98-18 Dated October 7, 1998), are applicable to the aircraft above when the following equipment is installed:

SYSTEM: Airwolf Remote Mount Oil Filter System.

Airwolf Filter Corp
15369 Madison Rd
Middlefield, OH 44062



ITEM	CHECKLIST INFORMATION
1.	<p>Introduction: This section briefly describes the aircraft, engine, propeller, or component that has been altered. Include and other information on the content, scope, purpose, arrangement, applicability, definitions, abbreviations, precautions, units of measurement, referenced publications, and distribution of the ICA as applicable.</p> <p>Comment: <u>Schweizer Model 269 A, B, C & 300C</u> with Lycoming <u>O/HO/HIO-360 Series</u> <i>Aircraft Model</i> <i>Engine Model</i></p>
2.	<p>Description: Of the major alteration, it's function including an explanation of it's interface with other systems, if any.</p> <p>Comment: Installation of Airwolf Remote Mounted Oil Filter Kit P/N AFC-K004</p>
3.	<p>Control: Operation information: Or special procedures if any.</p> <p>Comment: Pre-heating of both the engine and engine oil is recommended prior to starting the engine during periods of cold weather where the temperature is 30°F or below.</p>
4.	<p>Servicing information: Such as types of fluids used, servicing points, and location of access panels, as appropriate.</p> <p>Comment: Oil System to be serviced in accordance with Lycoming Service Bulletin 480C or higher. Oil should be changed at least once each 12 months. Cut the old filter open with Airwolf AFC-470 oil filter cutter at each oil change and inspect for metal contamination or any evidence that may indicate impending engine problems.</p>
5.	<p>Maintenance Instructions: Such as recommended inspection/maintenance periods in which each of the major alteration components are inspected, cleaned, lubricated, adjusted, tested, including applicable wear tolerances and work recommended at each scheduled maintenance period. This section can refer to the manufactures instructions for the equipment installed where appropriate e.g. functional checks, repairs, inspections.) It should also include any special notes, cautions, or warnings as applicable.</p> <p>Comment: Inspect for security at each annual or 100 hr . inspection. After any oil change, always ground run the engine and check for leaks before flight.</p>
6.	<p>Trouble shooting information: Information describing probably malfunctions, how to recognize those malfunctions, and the remedial actions to be taken.</p> <p>Comment: <u>N/A</u></p>
7.	<p>Removal and replacement information: This section describes the order and method of removing and replacing products, parts, and any necessary precautions. This section should also describe or refer to the manufacture's instructions to make required tests trim checks, alignment, calibrations, center of gravity changes, lifting or shoring, etc., if any.</p> <p>Comments: <u>N/A</u></p>
8.	<p>Diagrams: Of access plates and information, if needed, to gain access for inspection.</p> <p>Comment: <u>N/A</u></p>
9.	<p>Special inspection requirements: Such as X-ray, ultrasonic testing, or magnetic particle inspection, if required.</p> <p>Comment: <u>N/A</u></p>
10.	<p>Application of protective treatments: To the affected area after inspection and/or maintenance, if any.</p> <p>Comment: <u>N/A</u></p>

INSTRUCTIONS FOR CONTINUED AIRWORTHINESS

Form AFC-K004-ICA Revised 10/01/00

11.	Data: Relative to structural fasteners such as type, torque, and installation requirements if any. Comment: __N/A
12.	List of special tools: Special tools that are required, if any. Comment: __N/A
13.	For commuter category aircraft: The following additional information must be furnished, as applicable: <ul style="list-style-type: none"> A. Electrical Loads B. Methods of balancing flight controls. C. Identification of primary and secondary structures> D. Special repair methods applicable to the airplane. Comment: __N/A
14.	Recommended overhaul periods: Are required to be noted on the ICA when an overhaul period has been set by the manufacturer of a component, or equipment. If there is no overhaul period, the ICA should state for item 14: "No additional overhaul time limitations." Comment: __N/A
15.	Airworthiness Limitation Section: Include any "approved" airworthiness limitations identified by the manufacturer of FAA type Certificate Holding Office (e.g., An STC incorporated in a larger field approved major alteration may have an airworthiness limitation.) The FAA inspector should not establish, alter, or cancel airworthiness limitations without coordinating with the appropriate FAA type Certificate Holding Office. If there are no changes to the airworthiness limitations, the ICA should state for item 15: "No additional airworthiness limitations" or "Not Applicable." Comment: __N/A
16.	Revision: This section should include information on how to revise the ICA. For example, a letter will be submitted to the local FSDO with a copy of the revised FAA Form 337 and revised ICA. The FAA inspection accepts the change by signing Block 3 and including the following statement: "The attached revised/new Instructions for Continued Airworthiness (date_____) for the above aircraft or component major alteration have been accepted by the FAA, superseding the Instructions for Continued Airworthiness (date_____)." Once the revision has been accepted, a maintenance record entry will be made, identifying the revision, its location, date of the Form 337. Comment: __ A letter will be submitted to the local FSDO with a copy of the revised FAA Form 337 and revised ICA. The FAA inspector accepts the change by signing Block 3 and including the following statement: "The attached revised/new Instructions for Continued Airworthiness (date_____) for the above aircraft or component major alteration have been accepted by the FAA, superseding the Instructions for Continued Airworthiness (date_____)." Once the revision has been accepted, a maintenance record entry will be made, identifying the revision, its location, date of the Form 337.

NOTE:

Implementation and Record Keeping: For major alterations performed in accordance with FAA Field Approval policy, the owner operator operating under part 91 is responsible for ensuring that the ICA is made part of the applicable section 92.409 inspection program for their aircraft. This is accomplished when a maintenance entry is made in the aircraft's maintenance record in accordance with section 43.9. This entry recorded the major alteration and identifies the original ICA location (e.g., Block 8 of FAA Form 337, dated 5/28/98) along with a statement that the ICA is now part of the aircraft's inspection/maintenance requirements.

For major alterations performed in accordance with field approval on air carrier aircraft, the air carrier operator is responsible for ensuring that the ICA is made part of the applicable inspection/maintenance program for their aircraft. If a procedure is not currently included in the operator's manual to incorporate ICA, this process will need to be appropriately addressed (i.e. the operator submits a revision to its maintenance program to the applicable certificate-holding district office (CHDO)).

For aircraft inspected under an Approved Aircraft Inspection Program (AAIP), the operator will submit a change to the CHDO in accordance with section 135.419b).

For air carrier aircraft inspected using an annual/100 hour inspection program, a reference to the new ICA will be made in the aircraft's maintenance record in accordance with section 43.9. This entry records the major alteration and identifies the original ICA location (e.g., ICA are located/attached to Block 8 of FAA Form 337, dated 5/28/98). In addition, the operator will request a revision to the operator's Operations Specifications, additional maintenance requirements, which incorporates the ICA into the inspection program.

ASSEMBLY DRAWING# AFC-D-0007

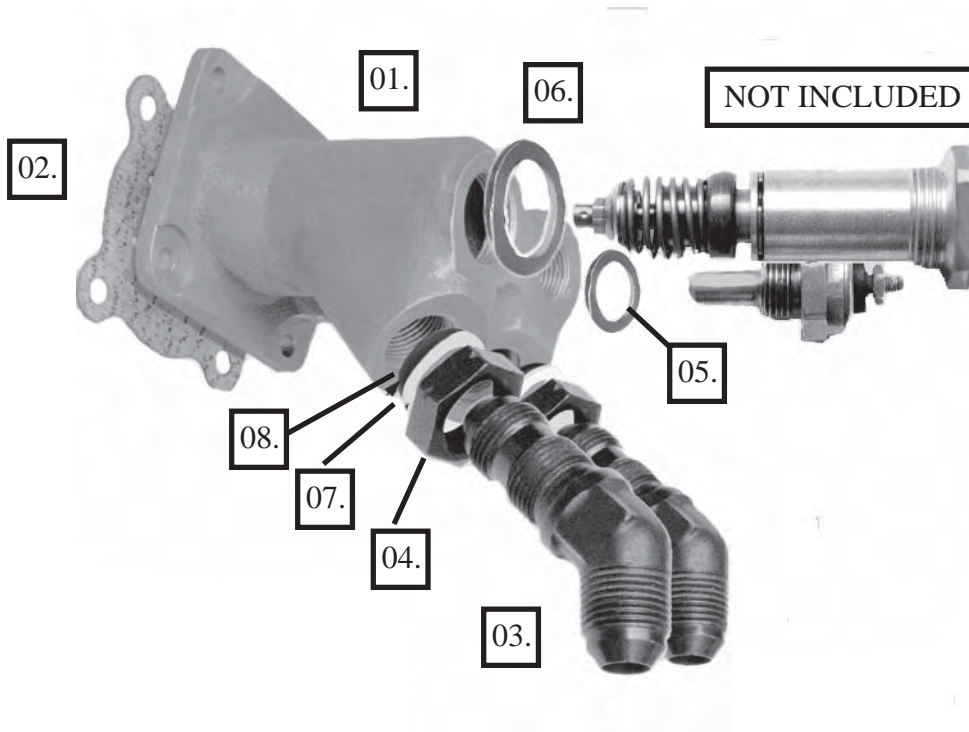

MATERIALS LIST:

Index	Part Number	Description	QTY
01	LYC-10	Adapter - engine, full flow	(1)
02	61173	Oil Filter Gasket	(1)
03	AN837-8D	Bulkhead Fitting, 45°	(2)
04	AN6289-8D	Bulkhead Nut	(2)
05	MS35769-11	Gasket, Oil Temperature Sens	(1)
06	MS35769-21	Gasket, Thermostatic Valve	(1)
07	MS28773-08	Boss Gasket	(2)
08	MS9387-08	"O" Ring	(2)

Revisions	<h2 style="margin: 0;">Airwolf Filter Corp.</h2> <p style="margin: 0;">Assembly Drawing. LYC-10 Adapter - Engine, Full Flow</p>		
	12/05/92	Dwg# AFC-D-0007	John P. Kochy

INSTALLATION DRAWING# AFC-D-0009

MATERIALS LIST:

Index	Part Number	Description	QTY
11	OFM-14	Oil Filter Mount	1
17	38B0100008D0211	Hose Assy	2
18	MS21919DG-10	Clamp	2
19	AN3-4A	Bolt	6
20	AN960-10	Washer	12
21	MS20365-1032	Locknut	6

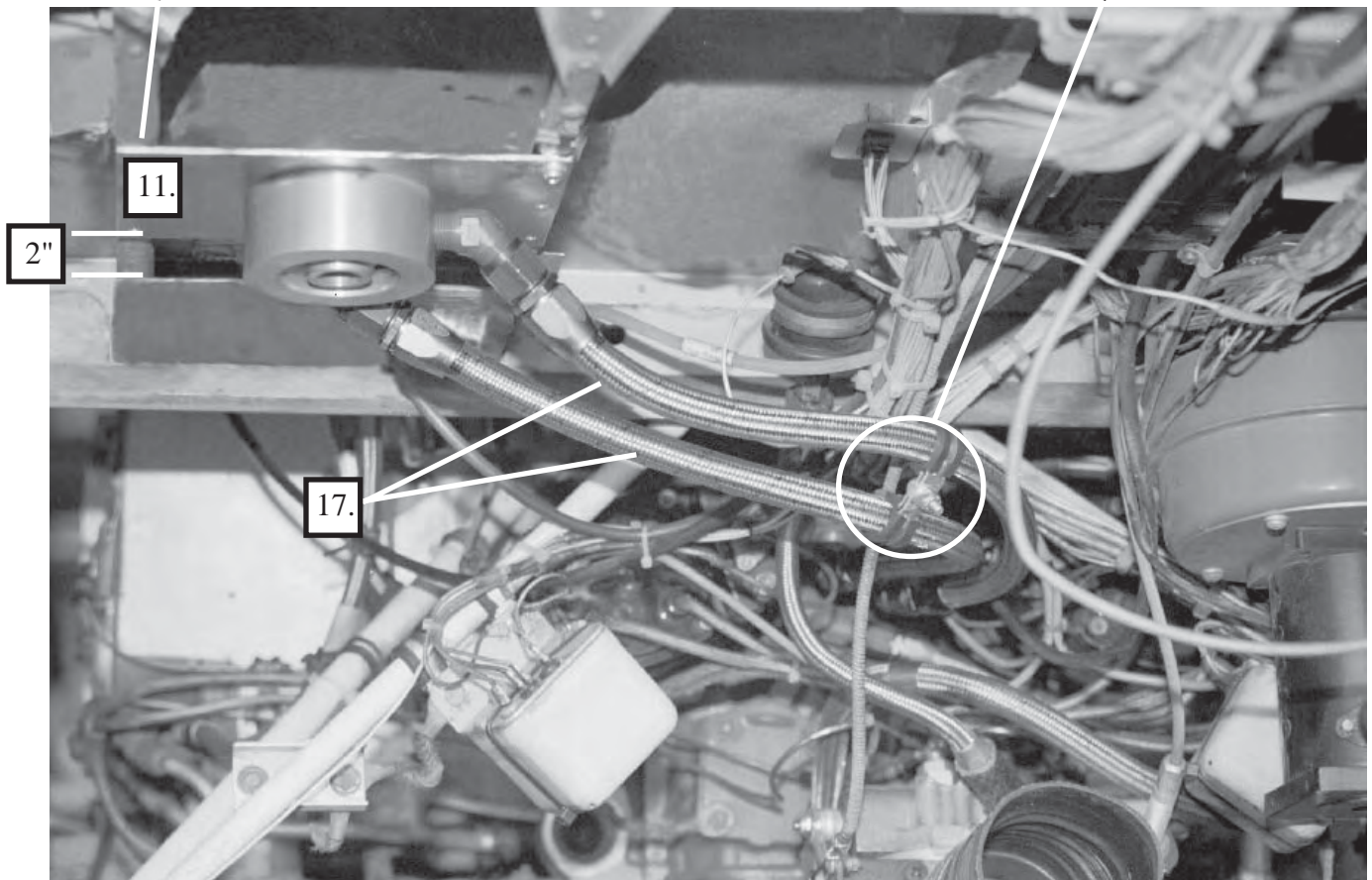
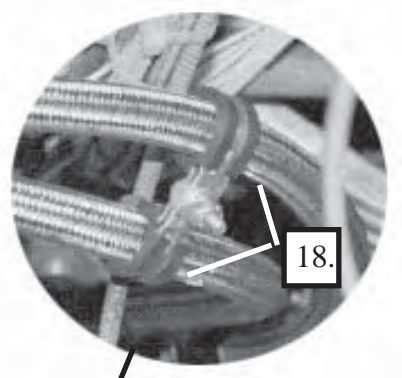
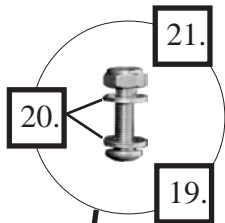

Revisions

Airwolf Filter Corp.

Installation Drawing. OFM-14 Filter Mount Plate
Schweizer 269A, B, & C (RH Installation)

12/05/92

Dwg# AFC-D-0009

John P. Kochy

ASSEMBLY DRAWING# AFC-D-0010

MATERIALS LIST:

Index	Part Number	Description	QTY
11	OFM-14	Oil Filter Mount	1
17	38B0100008D0211	Hose Assy	2
18	MS21919DG-10	Clamp	2
19	AN3-4A	Bolt	6
20	AN960-10	Washer	12
21	MS20365-1032	Locknut	6

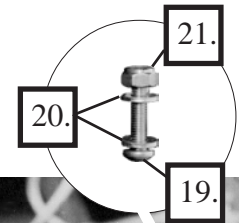
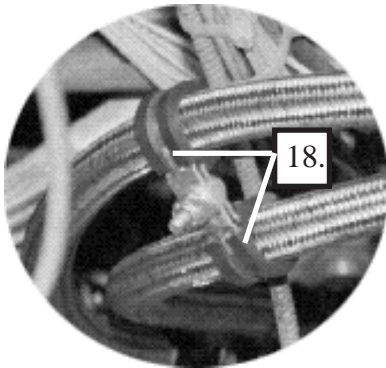

Revisions

Airwolf Filter Corp.

Installation Drawing. OFM-14 Filter Mount Plate
Schweizer 269A, B, & C (LH Installation)

12/05/92

Dwg# AFC-D-0010

John P. Kochy

ASSEMBLY DRAWING# AFC-D-0011

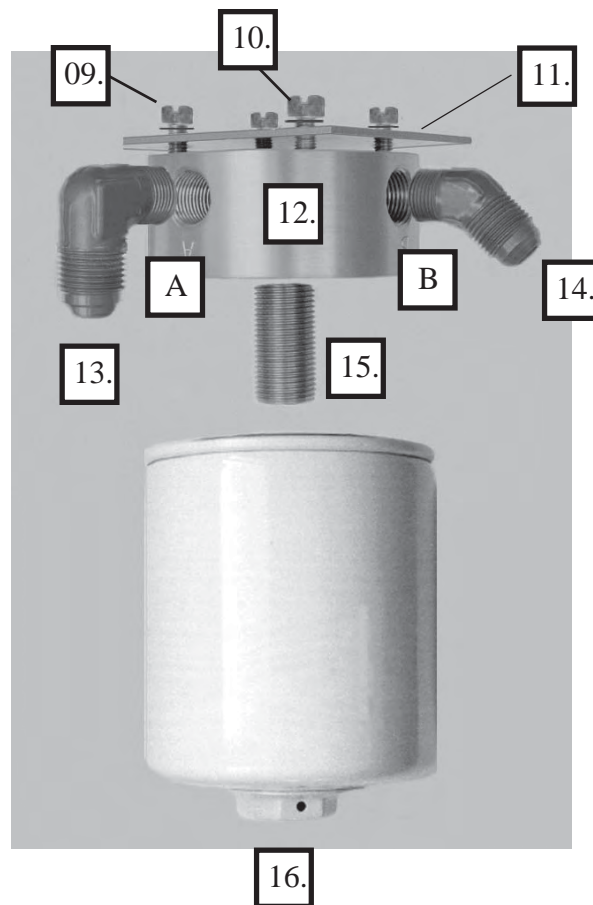

MATERIAL LIST

Index	Part Number	Description	Qty
09.	AN4H-AA	Bolt, Drilled Head	(4)
10.	AN960-416	Flat Washers	(4)
11.	OFM-14	Oil Filter Mount-269A,B,C	(1)
12.	OFB-10	Oil Filter Base	(1)
13.	MS20822-8D	Fitting, 90°	(1)
14.	MS20823-8D	Fitting, 45°	(1)
15.	OFS-10	Oil Filter Stud	(1)
16.	AFC-500	Oil Filter	(1)

Revisions	Airwolf Filter Corp.		
	Assembly Drawing. OFB-10 Oil Filter Base Schweizer 269A, B, & C (LH Installation)		
	12/05/92	Dwg# AFC-D-0011	John P. Kochy

ASSEMBLY DRAWING# AFC-D-0012

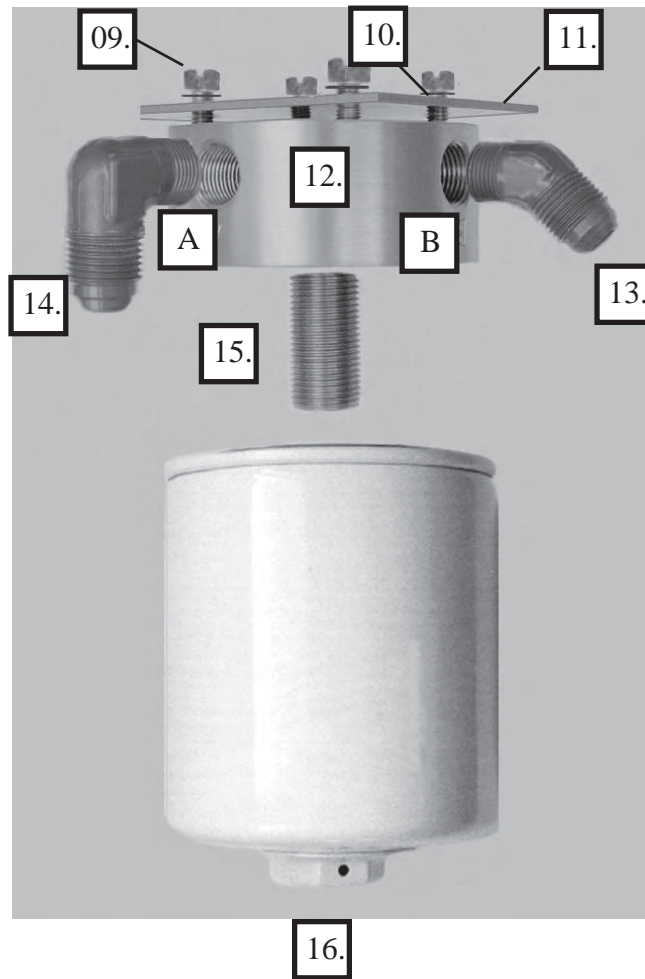

MATERIAL LIST

<u>Index</u>	<u>Part Number</u>	<u>Description</u>	<u>Qty</u>
09.	AN4H-4A	Bolt, Drilled Head	(4)
10.	AN960-416	Flat Washers	(4)
11.	OFM-14	Oil Filter Mount-269A,B,C	(1)
12.	OFB-10	Oil Filter Base	(1)
13.	MS20822-8D	Fitting, 90°	(1)
14.	MS20823-8D	Fitting, 45°	(1)
15.	OFS-10	Oil Filter Stud	(1)
16.	AFC-500	Oil Filter	(1)

Revisions	Airwolf Filter Corp.					
	Assembly Drawing. OFB-10 Oil Filter Base Schweizer 269A, B, & C (RH Installation)					
	12/05/92	Dwg# AFC-D-0012	John P. Kochy			

WEIGHT AND BALANCE REPORT

SCHWEIZER 269A, B, & C

RH INSTALLATION

[illegible]

WEIGHT AND BALANCE REPORT

SCHWEIZER 269A, B, & C

LH INSTALLATION

[illegible]



Reference Data
for
AFC-K004-II
for
STC SH1065NE
Oil Filter Kit
AFC-K004

Dated: 4/2/2021

Airwolf Filter, Corp
12801 Hwy. 75 N.
OKMULGEE, OK 74447
(918) 561-8696 Ph
(918) 561-8695 Fx

List of Effective Pages

[illegible][illegible]

Table of Contents

<u>Section</u>	<u>Page</u>
List of Effective Pages.....	1
Table of Contents.....	2
STOP, To the Mechanic	3
Data Pertinent to all Installations	4
Warnings and Notes.....	5
Illustrated Parts List.....	6
Installation Instructions.....	7
Installation Instructions (Continued).....	8
Weight and Balance Work sheets.....	9
Assembly Drawing AFC-D-0007 (LYC-10 Adapter- Engine, Full Flow)	10
Assembly Drawing AFC-D-0009 (OFM-14 Oil Filter Mount Plate - RH Installation)	11
Installation Drawing AFC-D-0010 (OFM-14 Oil Filter Mount Plate - LH Installation)	12
Assembly Drawing AFC-D-0011 (OFB-10 Oil Filter Base LH Installation)	13
Assembly Drawing AFC-D-0012 (OFB-10 Oil Filter Base RH Installation)	14



READ THIS BEFORE INSTALLING OIL FILTER KITS, DATA PERTINENT TO ALL INSTALLATIONS

TO THE MECHANIC:

This P/N AFC-K004 remote mount oil filter kit incorporates our STC approved for Schweizer 269A, B, & C Helicopters. Powered by Lycoming engine models HO-360-B1A, HO-360-B1B, HIO-360-A1A, HIO-360-B1A, HIO-360-B1B, HIO-360-D1A, & O-360-C2D.

Upon installing this filter kit, you will need to fill out and file a 337 form for this installation referencing the P/N AFC- K004 kit and the STC# SH1065NE.

If you have any questions or concerns on this STC, please call Airwolf Filter Corp, which we will clarify the details. Personnel are very familiar with our filter kits and can address any concerns you may have on your installation.

Airwolf Filter Corp
12801 Hwy 75 N.
Okmulgee, OK 74447
Phone: (918) 561-8696
Fax: (918) 561-8695

After completion of the installation of this kit, place a copy of the instructions along with the ICA in the Aircraft records for maintenance and replacement parts identification.

DATA PERTINENT TO ALL INSTALLATIONS

Prior to installing the filter kit on the aircraft, weigh the filter kit, add the weight of the hoses, and subtract the oil screen or oil filter adapter removed from the engine, and determine the net weight being added to the aircraft for determining the weight and balance of the aircraft later. Once the filter kit is installed on the aircraft, if you choose to purchase the hoses from Airwolf, we will supply you with the Hoses specified in this STC. At the time of the order, we will need the flare-to-flare length of the hoses, and hose ends needed on each hose i.e.: Straight to Straight, Straight to 90°, Straight to 45°, etc. allowing for engine torque and vibration per AC43.13.

If our instructions do not specifically say you can do something, assume that means you are not allowed to do it without our written approval.

1. Review all installation data and written material before beginning.
2. Please inspect contents of kit and inventory components before beginning.
3. **Do not** over tighten the fittings on Adapters or housings. This can distort or crack housings, causing oil to leak.
4. It is **EXTREMELY** important that oil lines be routed properly in accordance with AC 43.13-1A & 2A Acceptable Methods and Practices. (see Tip below)
5. See Warnings and Notes contained in the instructions concerning routing of lines and the use of sealant on NPT fittings.

DO NOT USE TEFLON TAPE ON FITTINGS.

6. The use of sealant on AN/Flared type fittings is not required, it is only required on NPT fittings.
7. When mounting Adapters use the supplied doublers for reinforcing mounting locations.
8. **BE PATIENT!!!** Take your time and you will see the results of your effort.

TIP

How to get correct length of hose

Hose length is measured from flare to flare. Do not use a string or a tape measure but take a section of old garden hose. Touch one end of the garden hose to the tip of one fitting and touch the other end of the hose to the other fitting, that is the correct length of hose needed. The garden hose is trying to bend to its natural set, which is normally the extra needed for engine torque and vibration per AC43.13, Also, if you kink a garden hose, you are obviously going to kink an aircraft hose. Doing it this way allows you to snake a hose across the back of an engine and around obstacles and this will replicate exactly how the aircraft hose will fit.

Thank you for taking the time to read this.

WARNINGS & NOTES

***** WARNING (A) *****

USE LOCTITE® BRAND 567 TEFLON THREAD SEALANT BEFORE INSTALLATION OF FITTINGS. DO NOT ASSEMBLE FITTINGS INTO OIL FILTER BASE WITHOUT SEALANT OTHERWISE GALLING OF MATERIAL WILL RESULT.

***** WARNING (B) *****

NO ROUTING OF FLAMMABLE FLUID LINES ABOVE EXHAUST SYSTEM, UNLESS FIRESLEEVED. INSTALLER IS RESPONSIBLE FOR INTER-RELATIONSHIP BETWEEN THIS AND OTHER ENGINE CHANGES (INCLUDING ACCESSORIES)

***** WARNING (C) *****

THE USE OF PARTS AND COMPONENTS NOT INCLUDED IN THE KIT, IS NOT COVERED BY THE STC APPROVAL. ALWAYS REMEMBER THAT THE DIRTY OIL FROM THE ENGINE ENTERS THE OIL FILTER FROM THE OUTSIDE OF THE FILTER. THE CLEAN OIL EXITS THROUGH THE LARGE HOLE IN THE CENTER OF THE OIL FILTER AND RETURNS TO THE ENGINE.

***** WARNING (D) *****

DO NOT, UNDER ANY CIRCUMSTANCES, CONNECT AN OIL COOLER THAT DOES NOT HAVE A THERMOSTATIC CONTROL VALVE, IN SERIES WITH OUR REMOTE MOUNT OIL FILTER KIT. OUR FILTER KIT IS A "FULL FLOW" OIL FILTERING SYSTEM WHICH MEANS ALL OF THE OIL IS FILTERED ALL OF THE TIME. DURING STARTUP ON A COLD DAY, THE COLD THICK OIL WILL PARTIALLY BYPASS A CH48108 OR CH48109 OIL FILTER UNTIL THE VISCOSITY DROPS AND THE THIN OIL CAN FLOW THROUGH THE FILTER MEDIA THEREBY ALLOWING OIL TO CIRCULATE IN THE ENGINE. IF AN OIL COOLER HAS NO THERMOSTATIC BYPASS BUILT INTO THE UNIT, WHEN THE OIL FILTER GOES INTO PARTIAL BYPASS, THIS THICK SLUG OF OIL WILL BE STOPPED, OR SEVERELY RESTRICTED AT THE OIL COOLER. ONE OF THREE THINGS WILL HAPPEN:

1. THE OIL COOLER WILL SEPARATE IN HALF.
2. THE OIL FILTER GASKET WILL FAIL AND/OR THE OIL FILTER WILL EXPLODE.
3. THE OIL HOSE WILL FAIL

ANY OF THE THREE SCENARIOS ABOVE WILL CAUSE COMPLETE LOSS OF OIL IN A SHORT PERIOD OF TIME.

NOTE:

COMMON TO ALL INSTALLATIONS

SOME HOSES OR WIRES MAY HAVE TO BE REROUTED SO THE OIL FILTER ASSEMBLY WILL FIT INTO POSTION. REFERENCE AND MATERIAL PER AC 43.13-1B & 2A.

Illustrated Parts List AFC-K004-PL**Applicability:**

Schweizer Model 269A, B, C, & 300C with Lycoming Engines HO-360-B1A, HO-360-B1B, HIO-360-A1A, HIO-360-B1A, HIO-360-B1B, HIO-360-D1A, & O-360-C2D.

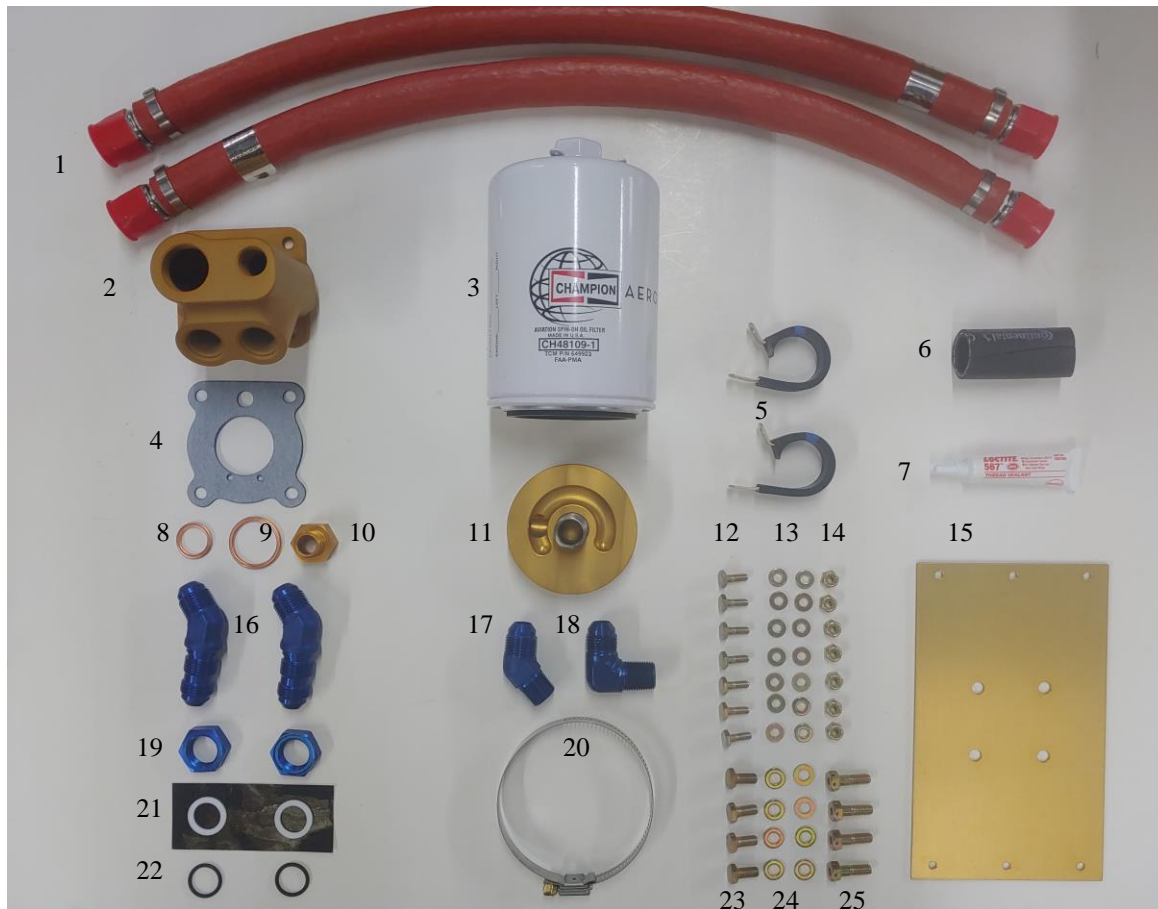
**Parts List No. AFC-K004-PL**

Index	Part Number	Description	Quantity
1	38B0100008D0211	Hose Assy	2
2	LYC-10	Adapter- Engine, Full Flow	1
3	AFC-500 or AFC-600	Oil Filter, or Equivalent [Champion CH48108/CH48109]	1
4	61173 or GT-61173	Adapter Base Gasket	1
5	MS21919DG-10	Adel Clamp	2
6	MIL6000-3/4-2	Dampener, Vibration	1
7	567	Loctite Thread Sealant	1
8	MS35769-11	Gasket, Oil Temperature Sensor	1
9	MS35769-21	Gasket, Thermostatic Valve	1
10	CAP-1350	Bypass Valve Cap (optional)	1
11	OFB-10	Oil Filter Base(with OFS-10 Installed)	1
12	AN3-4A	Bolt	7
13	AN960-10	Flat Washer	14
14	MS20365-1032A	Locknut	7
15	OFM-14	Oil Filter Mount, 269 A, B, C	1
16	AN837-8D	Bulkhead Fitting, 45 degree	2
17	MS20823-8D	Fitting, 45	1
18	MS20822-8D	Fitting, 90	1
19	AN6289-8D	Bulkhead Nut	2
20	QS100M52H	Clamp	1
21	MS28773-08	Boss Gasket	2
22	M83248/1-908	"O" Rings	2
23	AN4H-4A	Bolt, Drilled Head	4
24	AN960-416	Flat Washers	8
25	AN74A-6	Bolt Drilled Head	4

Installation Instructions No. AFC-K004-II

Applicability: Schweizer Model 269A, B, C, & 300C with Lycoming Engines HO-360-B1A, HO-360-B1B, HIO-360-A1A, HIO-360-B1A, HIO-360-B1B, HIO-360-D1A, & O-360-C2D.

Note A: Up until 1987 the optional Paravion cabin heater was usually located on the RH side of the helicopter. After 1987 and in helicopters using the optional searchlight, the Paravion heater can be found on the LH side of the helicopter. The AFC- K004 filter kit is designed to be used in either application. Airwolf Filter Corp. considers the standard configuration for the AFC-K004 oil filter kit to be the LH side of this helicopter.

1. Remove the Lycoming P/N 69510 engine oil screen housing from the accessory case.
2. Remove oil temperature sensor and thermostatic valve from old oil screen housing.
3. Per Assembly Drawing AFC-D-0007, install a new gasket (5) under the head of the oil temperature sensor, install in the engine adapter, full flow (1). Turn the oil temp sensor until the sealing surfaces are in contact and then tighten an additional 135 degrees. Install a new gasket (6) under the head of the P/N 75944 Lycoming thermostatic valve, install in the engine adapter, full flow (1), torque to 300 in/lbs. and secure with .032 MS20995-C safety wire.
4. Per Assembly Drawing AFC-D-0007, onto each bulkhead fitting (3), install **(in order)** 1 ea. bulkhead nut (4), boss gasket (7), and "O" Ring (8). Install each completed assembly into the engine adapter (1).
BE CAREFUL: O-ring and boss gasket must seal in the smooth area between the threaded areas of the bulkhead fitting. Do not tighten fittings until after routing of hoses has been determined in step 6c. or 7c.
5. Per assembly drawing AFC-D-0007, install a new gasket (2) on base of the engine adapter (1) and install onto the engine accessory case. On aircraft using the optional Schweizer throttle governor, install flat washers as necessary under the top and bottom throttle governor mounting plate to prevent mounting plate from contacting engine adapter, full flow (1) and torque to specifications 96 in/lbs.
- 6a. **LH INSTALLATION (Optional Paravion heater located on RH side of aircraft)**
Using installation drawing AFC-D-0010 as a reference, (facing forward), locate the LH tail rotor bell crank assy. under the LH side of the helicopter. Using the oil filter mount (1) as a template, position 2" forward of the LH tail rotor bell crank assy and drill (6) holes using a #10 drill.

**** SEE WARNING (A) ****
- 6b. Per Assembly Drawing AFC-D-0011, install fitting (5) into "**A**" port and fitting (6) into "**B**" port of the oil filter base (4) and position per Installation Drawing AFC-D-0010. Mount to oil filter mount (3) per Assembly Drawing AFC- D0011 using bolts (1) and washers (2), and secure with .032 MS20995-C safety wire. Per Installation Drawing AFC-D-0010, Install oil filter mount (1) & oil filter base assembly into previously drilled holes using six ea. bolts (4), washers (5), and locknuts (6).

**** SEE WARNING (B) ****
- 6c. Per Installation Drawing AFC-D-0010, install 2 ea. hose assy's connecting the "**A**" port on the engine adapter to the "**A**" port on the oil filter base and the "**B**" port on the engine adapter to the "**B**" port on the oil filter base. As per Installation Drawing AFC-D-0007, tighten bulkhead nuts (4) at this time and then tighten hose fittings to 270-350 in/lbs.

**** SEE WARNING (B) ****
- 6d. Per Installation Drawing AFC-D-0010, secure hoses using clamps (3), screws (4), washers (5), and nuts (6) provided.

(Continued)Installation Instructions No. AFC-K004-II**Applicability:**

Schweizer Model 269A, B, C, & 300C with Lycoming Engines HO-360-B1A, HO-360-B1B, HIO-360-A1A, HIO-360-B1A, HIO-360-B1B, HIO-360-D1A, & O-360-C2D.

7a. RH INSTALLATION (Optional Paravion heater located on LH side of aircraft)

Using Installation Drawing AFC-D-0009 as a reference, (facing forward), locate the RH tail rotor bell crank assy. under the RH side of the helicopter. Using the oil filter mount (1) as a template, position 2" forward of the RH tail rotor bell crank assy and drill (6) holes using a #10 drill.

**** SEE WARNING (A) ****

- 7b.** Per Assembly Drawing AFC-D-0012, install fitting (5) into "**A**" port and fitting (6) into "**B**" port of the oil filter base (4) and position per Installation Drawing AFC-D-0009. Mount to oil filter mount (3) per Assembly Drawing AFC-D0012 using bolts (1) and washers (2), and secure with .032 MS20995-C safety wire. Per Installation Drawing AFC-D-0009, install oil filter mount (1) & oil filter base assembly into previously drilled holes using six ea. bolts (4), washers (5), and locknuts (6). Assure adequate clearance between fitting (5) and tail rotor pulley guard bolt and install shorter bolt if necessary.

**** SEE WARNING (B) ****

- 7c.** Install 2 ea. hose assy's connecting the "**A**" port on the engine adapter to the "**A**" port on the oil filter base and the "**B**" port on the engine adapter to the "**B**" port on the oil filter base per drawing AFC-D-0009. Tighten bulkhead nuts (4) at this time and then tighten hose fittings to 270-350 in/ lbs.

**** SEE WARNING (B) ****

- 7d.** Per Installation Drawing AFC-D-0009, secure hoses using clamps (3), bolts (4), washers (5), and nuts (6) provided.

- 8.** Install oil filter, torque per instructions on oil filter and secure with .032 MS20995-C safety wire.

- 9.** Run engine and check for leaks.

- 10.** Determine weight and balance, initiate a 337 form, and update the equipment list.

**WEIGHT AND BALANCE REPORT
SCHWEIZER 269A, B, & C
RH INSTALLATION**

SURPLUS EQUIPMENT	WEIGHT	ARM-INCHES		MOMENT - IN/LBS.	
EQUIPMENT - ITEM	LBS.	LONG	LATR	LONG	LATR
REMOTE OIL FILTER	3.5	65.3	+ 13.1	228.6	+ 45.9

**WEIGHT AND BALANCE REPORT
SCHWEIZER 269A, B, & C
LH INSTALLATION**

SURPLUS EQUIPMENT	WEIGHT	ARM-INCHES		MOMENT - IN/LBS.	
EQUIPMENT - ITEM	LBS.	LONG	LATR	LONG	LATR
REMOTE OIL FILTER	3.5	65.3	- 13.1	228.6	- 45.9

AIRWOLF FILTER CORP PROPRIETARY

THIS DOCUMENT IS THE PROPERTY OF AIRWOLF FILTER CORP AND IS DELIVERED ON THE EXPRESS CONDITION THAT IT IS NOT TO BE DISCLOSED OR REPRODUCED IN WHOLE OR IN PART OR USED FOR MANUFACTURE FOR ANYONE OTHER THAN AIRWOLF FILTER CORP WITHOUT ITS WRITTEN CONSENT, AND THAT NO RIGHT IS GRANTED TO DISCLOSE OR SO USE ANY INFORMATION CONTAINED IN SAID DOCUMENT. THIS RESTRICTION DOES NOT LIMIT THE RIGHT TO USE INFORMATION OBTAINED FROM ANOTHER SOURCE.

REVISIONS

REV.	DESCRIPTION	BY	DATE
A	REDRAWN IN SOLIDWORKS	GM	12/15/2020

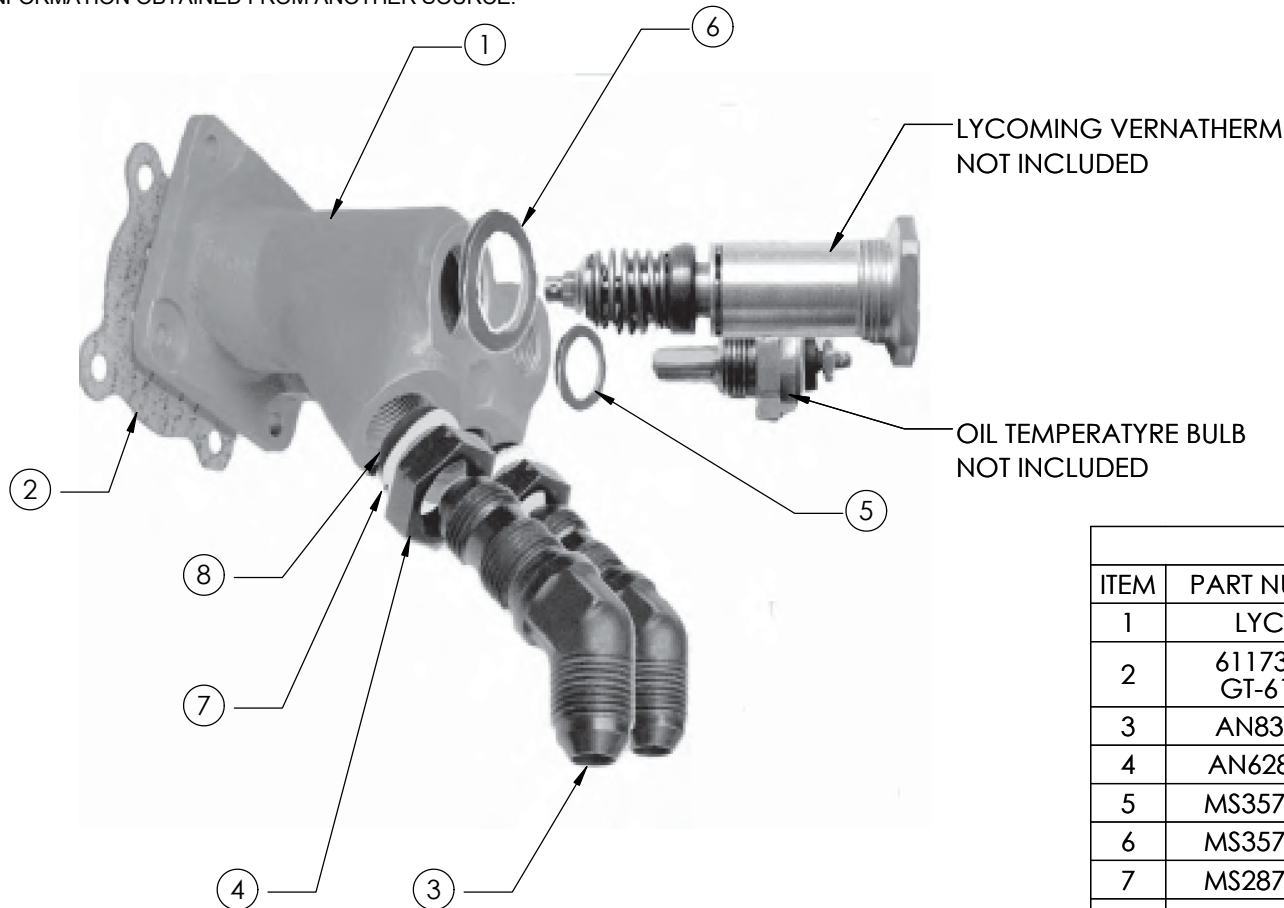

MATERIAL LIST

ITEM	PART NUMBER	DESCRIPTION	QTY.
1	LYC-10	ADAPTER - ENGINE, FULL FLOW	1
2	61173 OR GT-61173	ADAPTER GASKET	1
3	AN837-8D	BULKHEAD FITTING, 45°	2
4	AN6289-8D	BULKHEAD NUT	2
5	MS35769-11	GASKET, OIL TEMPERATURE SENSOR	1
6	MS35769-21	GASKET, THERMOSTATIC VALVE	1
7	MS28773-08	BOSS GASKET	2
8	M83248/1-908	"O" RING	2

		UNLESS OTHERWISE SPECIFIED:			NAME		DATE	Airwolf Filter Corp.	
		DIMENSIONS ARE IN INCHES			DRAWN	GM	12/15/2020	TITLE: ASSEMBLY DRAWING, LYC-10 ADAPTER - ENGINE, FULL FLOW	
		TOLERANCES:			APPR. BY	BDA	12/15/2020		
		1 PLACE ±.030			ENG APPR.				
		2 PLACE ±.010			MFG APPR.				
		3 PLACE ±.005			Q.A.			SIZE A	
		4 PLACE ±.0005							
		ANGULAR ±0°30'						DWG. NO.	REV
		INTERPRET GEOMETRIC TOLERANCING PER: ANSY Y 14.5H						AFC-D-0007	A
		MATERIAL							
NEXT ASSY	USED ON	FINISH			COMMENTS:			SCALE:	WEIGHT:
APPLICATION									SHEET 1 OF 1

THIS DOCUMENT IS THE PROPERTY OF AIRWOLF FILTER CORP AND IS DELIVERED ON THE EXPRESS CONDITION THAT IT IS NOT TO BE DISCLOSED OR REPRODUCED IN WHOLE OR IN PART OR USED FOR MANUFACTURE FOR ANYONE OTHER THAN AIRWOLF FILTER CORP WITHOUT ITS WRITTEN CONSENT, AND THAT NO RIGHT IS GRANTED TO DISCLOSE OR SO USE ANY INFORMATION CONTAINED IN SAID DOCUMENT. THIS RESTRICTION DOES NOT LIMIT THE RIGHT TO USE INFORMATION OBTAINED FROM ANOTHER SOURCE.

REVISIONS			
REV.	DESCRIPTION	BY	DATE
A	REDRAWN IN SOLIDWORKS	GM	12/15/2020

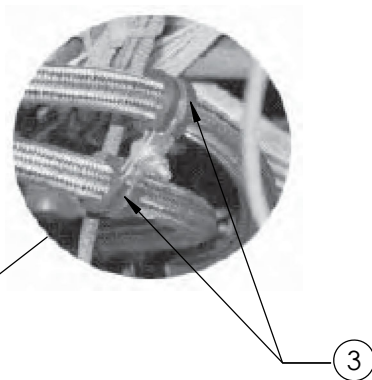
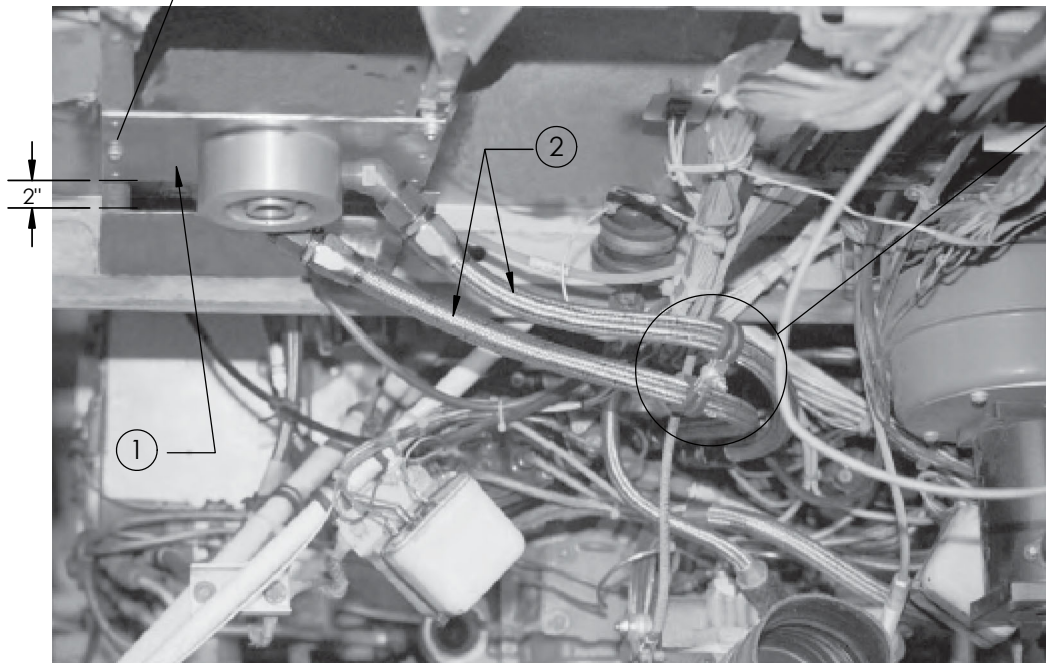
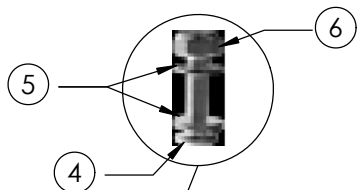

MATERIAL LIST			
ITEM	PART NUMBER	DESCRIPTION	QTY.
1	OFM-14	OIL FILTER MOUNT	1
2	38B0100008D0211	HOSE ASSY	2
3	MS21919DG-10	CLAMP	2
4	AN3-4A	BOLT	6
5	AN960-10	WASHER	12
6	MS20365-1032	LOCKNUT	6

		UNLESS OTHERWISE SPECIFIED:		NAME	DATE	Airwolf Filter Corp. TITLE: INSTALLATION DRAWING, OFM-14 FILTER MOUNT PLATE SCHWEIZER 269A, B, & C. (RH INSTALLATION)		
		DIMENSIONS ARE IN INCHES	DRAWN	GM	12/15/2020			
		TOLERANCES:	APPR. BY	BDA	12/15/2020			
		1 PLACE ±.030	ENG APPR.					
		2 PLACE ±.010	MFG APPR.					
		3 PLACE ±.005				SIZE A DWG. NO. AFC-D-0009 REV A		
		4 PLACE ±.0005						
		ANGULAR ±0°30'						
		INTERPRET GEOMETRIC TOLERANCING PER: ANSY Y 14.5H	Q.A.					
		MATERIAL						
						SCALE: WEIGHT: SHEET 1 OF 1		
						TITLE: INSTALLATION DRAWING, OFM-14 FILTER MOUNT PLATE SCHWEIZER 269A, B, & C. (RH INSTALLATION)		
						SIZE A DWG. NO. AFC-D-0009 REV A		
						SCALE: WEIGHT: SHEET 1 OF 1		
						TITLE: INSTALLATION DRAWING, OFM-14 FILTER MOUNT PLATE SCHWEIZER 269A, B, & C. (RH INSTALLATION)		
						SIZE A DWG. NO. AFC-D-0009 REV A		
						SCALE: WEIGHT: SHEET 1 OF 1		
						TITLE: INSTALLATION DRAWING, OFM-14 FILTER MOUNT PLATE SCHWEIZER 269A, B, & C. (RH INSTALLATION)		
						SIZE A DWG. NO. AFC-D-0009 REV A		
						SCALE: WEIGHT: SHEET 1 OF 1		
						TITLE: INSTALLATION DRAWING, OFM-14 FILTER MOUNT PLATE SCHWEIZER 269A, B, & C. (RH INSTALLATION)		
						SIZE A DWG. NO. AFC-D-0009 REV A		
						SCALE: WEIGHT: SHEET 1 OF 1		
						TITLE: INSTALLATION DRAWING, OFM-14 FILTER MOUNT PLATE SCHWEIZER 269A, B, & C. (RH INSTALLATION)		
						SIZE A DWG. NO. AFC-D-0009 REV A		
						SCALE: WEIGHT: SHEET 1 OF 1		
						TITLE: INSTALLATION DRAWING, OFM-14 FILTER MOUNT PLATE SCHWEIZER 269A, B, & C. (RH INSTALLATION)		
						SIZE A DWG. NO. AFC-D-0009 REV A		
						SCALE: WEIGHT: SHEET 1 OF 1		
						TITLE: INSTALLATION DRAWING, OFM-14 FILTER MOUNT PLATE SCHWEIZER 269A, B, & C. (RH INSTALLATION)		
						SIZE A DWG. NO. AFC-D-0009 REV A		
						SCALE: WEIGHT: SHEET 1 OF 1		
						TITLE: INSTALLATION DRAWING, OFM-14 FILTER MOUNT PLATE SCHWEIZER 269A, B, & C. (RH INSTALLATION)		
						SIZE A DWG. NO. AFC-D-0009 REV A		
						SCALE: WEIGHT: SHEET 1 OF 1		
						TITLE: INSTALLATION DRAWING, OFM-14 FILTER MOUNT PLATE SCHWEIZER 269A, B, & C. (RH INSTALLATION)		
						SIZE A DWG. NO. AFC-D-0009 REV A		
						SCALE: WEIGHT: SHEET 1 OF 1		
						TITLE: INSTALLATION DRAWING, OFM-14 FILTER MOUNT PLATE SCHWEIZER 269A, B, & C. (RH INSTALLATION)		
						SIZE A DWG. NO. AFC-D-0009 REV A		
						SCALE: WEIGHT: SHEET 1 OF 1		
						TITLE: INSTALLATION DRAWING, OFM-14 FILTER MOUNT PLATE SCHWEIZER 269A, B, & C. (RH INSTALLATION)		
						SIZE A DWG. NO. AFC-D-0009 REV A		
						SCALE: WEIGHT: SHEET 1 OF 1		
						TITLE: INSTALLATION DRAWING, OFM-14 FILTER MOUNT PLATE SCHWEIZER 269A, B, & C. (RH INSTALLATION)		
						SIZE A DWG. NO. AFC-D-0009 REV A		
						SCALE: WEIGHT: SHEET 1 OF 1		
						TITLE: INSTALLATION DRAWING, OFM-14 FILTER MOUNT PLATE SCHWEIZER 269A, B, & C. (RH INSTALLATION)		
						SIZE A DWG. NO. AFC-D-0009 REV A		
						SCALE: WEIGHT: SHEET 1 OF 1		
						TITLE: INSTALLATION DRAWING, OFM-14 FILTER MOUNT PLATE SCHWEIZER 269A, B, & C. (RH INSTALLATION)		
						SIZE A DWG. NO. AFC-D-0009 REV A		
						SCALE: WEIGHT: SHEET 1 OF 1		
						TITLE: INSTALLATION DRAWING, OFM-14 FILTER MOUNT PLATE SCHWEIZER 269A, B, & C. (RH INSTALLATION)		
						SIZE A DWG. NO. AFC-D-0009 REV A		
						SCALE: WEIGHT: SHEET 1 OF 1		
						TITLE: INSTALLATION DRAWING, OFM-14 FILTER MOUNT PLATE SCHWEIZER 269A, B, & C. (RH INSTALLATION)		
						SIZE A DWG. NO. AFC-D-0009 REV A		
						SCALE: WEIGHT: SHEET 1 OF 1		
						TITLE: INSTALLATION DRAWING, OFM-14 FILTER MOUNT PLATE SCHWEIZER 269A, B, & C. (RH INSTALLATION)		
						SIZE A DWG. NO. AFC-D-0009 REV A		
						SCALE: WEIGHT: SHEET 1 OF 1		
						TITLE: INSTALLATION DRAWING, OFM-14 FILTER MOUNT PLATE SCHWEIZER 269A, B, & C. (RH INSTALLATION)		
						SIZE A DWG. NO. AFC-D-0009 REV A		
						SCALE: WEIGHT: SHEET 1 OF 1		
						TITLE: INSTALLATION DRAWING, OFM-14 FILTER MOUNT PLATE SCHWEIZER 269A, B, & C. (RH INSTALLATION)		
						SIZE A DWG. NO. AFC-D-0009 REV A		
						SCALE: WEIGHT: SHEET 1 OF 1		
						TITLE: INSTALLATION DRAWING, OFM-14 FILTER MOUNT PLATE SCHWEIZER 269A, B, & C. (RH INSTALLATION)		
						SIZE A DWG. NO. AFC-D-0009 REV A		
						SCALE: WEIGHT: SHEET 1 OF 1		
						TITLE: INSTALLATION DRAWING, OFM-14 FILTER MOUNT PLATE SCHWEIZER 269A, B, & C. (RH INSTALLATION)		
						SIZE A DWG. NO. AFC-D-0009 REV A		
						SCALE: WEIGHT: SHEET 1 OF 1		
						TITLE: INSTALLATION DRAWING, OFM-14 FILTER MOUNT PLATE SCHWEIZER 269A, B, & C. (RH INSTALLATION)		
						SIZE A DWG. NO. AFC-D-0009 REV A		
						SCALE: WEIGHT: SHEET 1 OF 1		
						TITLE: INSTALLATION DRAWING, OFM-14 FILTER MOUNT PLATE SCHWEIZER 269A, B, & C. (RH INSTALLATION)		
						SIZE A DWG. NO. AFC-D-0009 REV A		
						SCALE: WEIGHT: SHEET 1 OF 1		
						TITLE: INSTALLATION DRAWING, OFM-14 FILTER MOUNT PLATE SCHWEIZER 269A, B, & C. (RH INSTALLATION)		
						SIZE A DWG. NO. AFC-D-0009 REV A		
						SCALE: WEIGHT: SHEET 1 OF 1		
						TITLE: INSTALLATION DRAWING, OFM-14 FILTER		

AIRWOLF FILTER CORP PROPRIETARY

THIS DOCUMENT IS THE PROPERTY OF AIRWOLF FILTER CORP AND IS DELIVERED ON THE EXPRESS CONDITION THAT IT IS NOT TO BE DISCLOSED OR REPRODUCED IN WHOLE OR IN PART OR USED FOR MANUFACTURE FOR ANYONE OTHER THAN AIRWOLF FILTER CORP WITHOUT ITS WRITTEN CONSENT, AND THAT NO RIGHT IS GRANTED TO DISCLOSE OR SO USE ANY INFORMATION CONTAINED IN SAID DOCUMENT. THIS RESTRICTION DOES NOT LIMIT THE RIGHT TO USE INFORMATION OBTAINED FROM ANOTHER SOURCE.

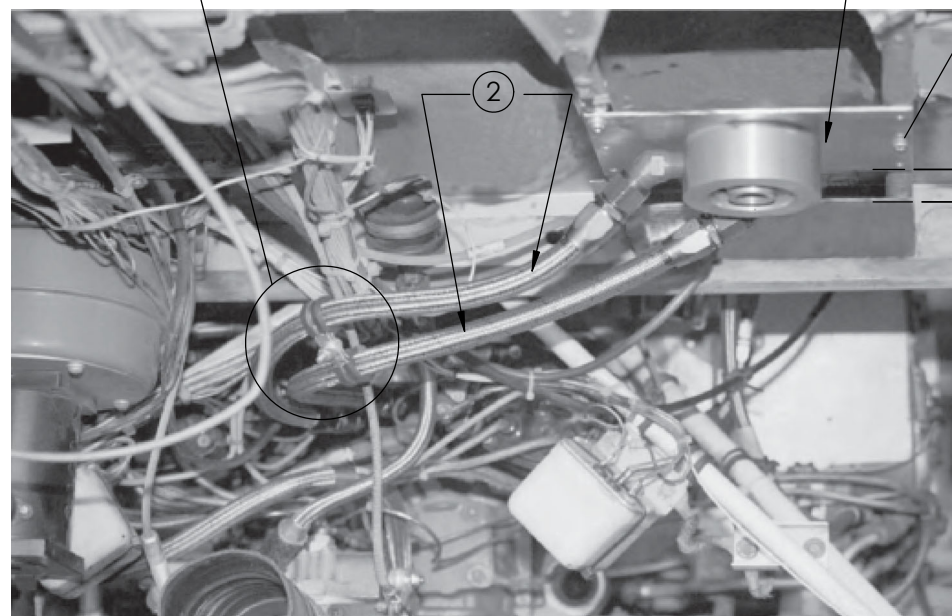
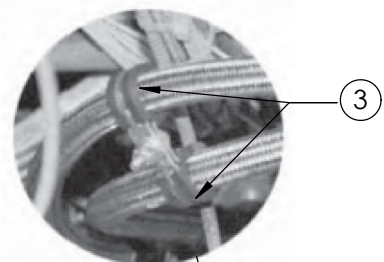

REVISIONS			
REV.	DESCRIPTION	BY	DATE
A	REDRAWN IN SOLIDWORKS	GM	12/15/2020

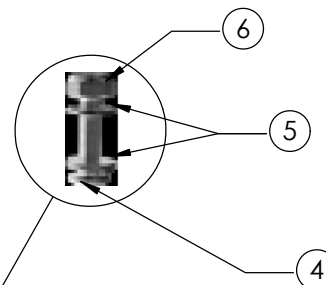

MATERIAL LIST			
ITEM	PART NUMBER	DESCRIPTION	QTY.
1	OFM-14	OIL FILTER MOUNT	1
2	38B0100008D0211	HOSE ASSY	2
3	MS21919DG-10	CLAMP	2
4	AN3-4A	BOLT	6
5	AN960-10	WASHER	12
6	MS20365-1032	LOCKNUT	6

		UNLESS OTHERWISE SPECIFIED:		NAME	DATE	Airwolf Filter Corp.			
		DIMENSIONS ARE IN INCHES	DRAWN	GM	12/15/2020				
		TOLERANCES:	APPR. BY	BDA	12/15/2020				
		1 PLACE ±.030	ENG APPR.						
		2 PLACE ±.010	MFG APPR.						
		3 PLACE ±.005				TITLE: INSTALLATION DRAWING, OFM-14 FILTER MOUNT PLATE SCHWEIZER 269A, B, & C, (LH INSTALLATION)			
		4 PLACE ±.0005							
		ANGULAR ±0°30'							
		INTERPRET GEOMETRIC	Q.A.						
		TOLERANCING PER: ANSY Y 14.5H							
		MATERIAL				SIZE	DWG. NO.		REV
NEXT ASSY	USED ON	FINISH	COMMENTS:			A	AFC-D-0010		A
APPLICATION						SCALE:	WEIGHT:	SHEET 1 OF 1	

AIRWOLF FILTER CORP PROPRIETARY

THIS DOCUMENT IS THE PROPERTY OF AIRWOLF FILTER CORP AND IS DELIVERED ON THE EXPRESS CONDITION THAT IT IS NOT TO BE DISCLOSED OR REPRODUCED IN WHOLE OR IN PART OR USED FOR MANUFACTURE FOR ANYONE OTHER THAN AIRWOLF FILTER CORP WITHOUT ITS WRITTEN CONSENT, AND THAT NO RIGHT IS GRANTED TO DISCLOSE OR SO USE ANY INFORMATION CONTAINED IN SAID DOCUMENT. THIS RESTRICTION DOES NOT LIMIT THE RIGHT TO USE INFORMATION OBTAINED FROM ANOTHER SOURCE.

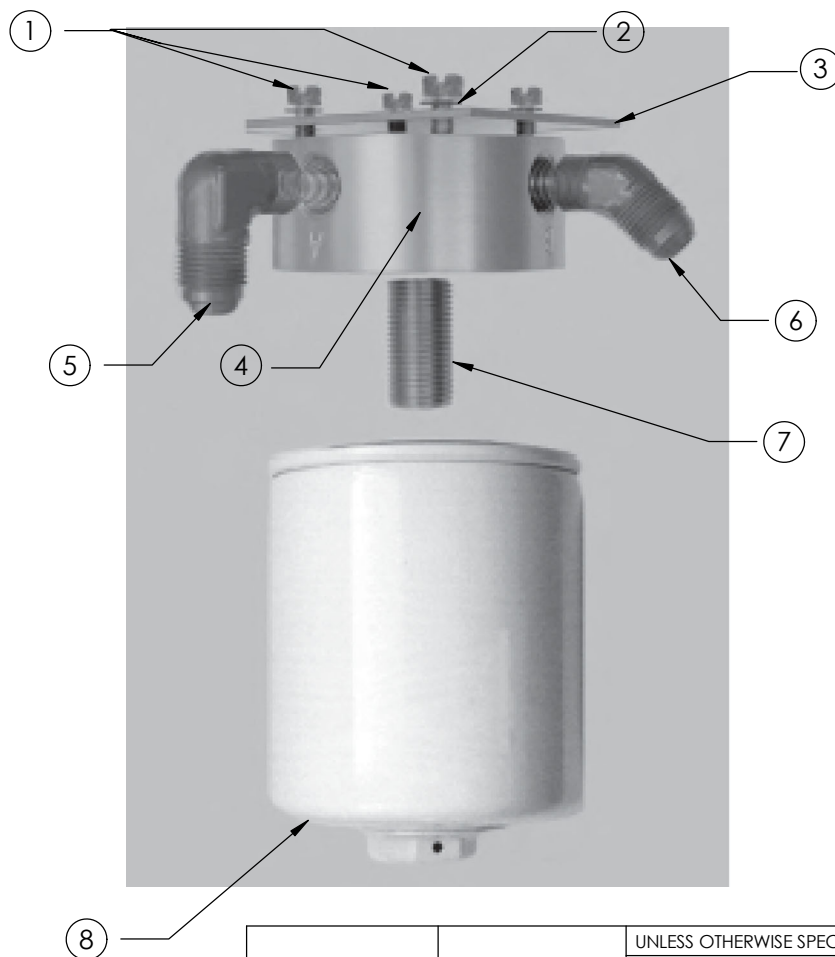

REVISIONS

REV.	DESCRIPTION	BY	DATE
A	REDRAWN IN SOLIDWORKS	GM	12/15/2020

MATERIAL LIST

ITEM	PART NUMBER	DESCRIPTION	QTY.
1	AN4H-4A	BOLT, DRILLED HEAD	4
2	AN960-416	FLAT WASHERS	4
3	OFM-14	OIL FILTER MOUNT-269A,B,C	1
4	OFB-10	OIL FILTER BASE	1
5	MS20822-8D	FITTING, 90°	1
6	MS20823-8D	FITTING, 45°	1
7	OFS-10	OIL FILTER STUD	1
8	AFC-500	OIL FILTER	1

UNLESS OTHERWISE SPECIFIED:

DIMENSIONS ARE IN INCHES
TOLERANCES:

1 PLACE ± 0.030
2 PLACE ± 0.010
3 PLACE ± 0.005
4 PLACE ± 0.0005
ANGULAR $\pm 0^{\circ}30'$

INTERPRET GEOMETRIC
TOLERANCING PER: ANSY Y 14.5H

MATERIAL

FINISH

	NAME	DATE
DRAWN	GM	12/15/2020
APPR. BY	BDA	12/15/2020
ENG APPR.		
MFG APPR.		
Q.A.		

Airwolf Filter Corp.

TITLE:

ASSEMBLY DRAWING, OFB-10
OIL FILTER BASE SCHWEIZER
269A, B & C, (LH INSTALLATION)

SIZE	DWG. NO.	REV
A	AFC-D-0011	A
SCALE:	WEIGHT:	SHEET 1 OF 1

NEXT ASSY	USED ON	
APPLICATION		

AIRWOLF FILTER CORP PROPRIETARY

THIS DOCUMENT IS THE PROPERTY OF AIRWOLF FILTER CORP AND IS DELIVERED ON THE EXPRESS CONDITION THAT IT IS NOT TO BE DISCLOSED OR REPRODUCED IN WHOLE OR IN PART OR USED FOR MANUFACTURE FOR ANYONE OTHER THAN AIRWOLF FILTER CORP WITHOUT ITS WRITTEN CONSENT, AND THAT NO RIGHT IS GRANTED TO DISCLOSE OR SO USE ANY INFORMATION CONTAINED IN SAID DOCUMENT. THIS RESTRICTION DOES NOT LIMIT THE RIGHT TO USE INFORMATION OBTAINED FROM ANOTHER SOURCE.

REVISIONS			
REV.	DESCRIPTION	BY	DATE
A	REDRAWN IN SOLIDWORKS	GM	12/15/2020

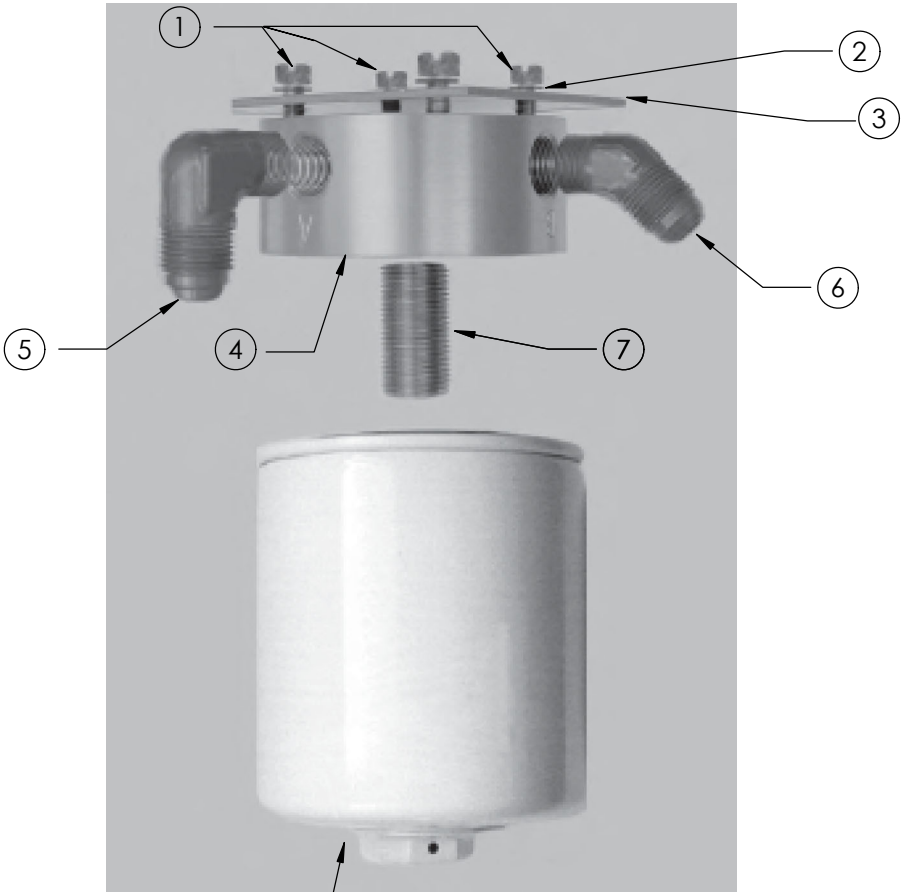

MATERIAL LIST			
ITEM	PART NUMBER	DESCRIPTION	QTY.
1	AN4H-4A	BOLT, DRILLED HEAD	4
2	AN960-416	FLAT WASHERS	4
3	OFM-14	OIL FILTER MOUNT-269A, B, C	1
4	OFB-10	OIL FILTER BASE	1
5	MS20822-8D	FITTING, 90 °	1
6	MS20823-8D	FITTING, 45 °	1
7	OFS-10	OIL FILTER STUD	1
8	AFC-500	OIL FILTER	1

⑧			UNLESS OTHERWISE SPECIFIED:		NAME	DATE	Airwolf Filter Corp.			
			DIMENSIONS ARE IN INCHES TOLERANCES: 1 PLACE ±.030 2 PLACE ±.010 3 PLACE ±.005 4 PLACE ±.0005 ANGULAR ±0°30'	DRAWN	GM	12/15/2020	TITLE:	ASSEMBLY DRAWING, OFB-10 OIL FILTER BASE SCHWEIZER 269A, B, & C (RH INSTALLATION)		
				APPR. BY	BDA	12/15/2020				
				ENG APPR.						
				MFG APPR.						
			INTERPRET GEOMETRIC TOLERANCING PER: ANSY Y 14.5H	Q.A.						
			MATERIAL				SIZE	DWG. NO.	REV	
	NEXT ASSY	USED ON	FINISH	COMMENTS:			A	AFC-D-0012	A	
APPLICATION						SCALE:	WEIGHT:	SHEET 1 OF 1		